



# SW PLUS

INNOVATIVE SUSTAINABILITY





**High performance enclosed in modern design**

State-of-the-art design that seamlessly combines versatility and hygiene. Easily cleanable surfaces, a user-friendly display and optimised functions ensure everyday practicality, boosting the effectiveness and quality of sterilisation procedures.



**Cycle times and Modular Drying**  
Thanks to reliable high-performance internal components, the autoclave meets even the most demanding requirements. The control system optimises the process while the exclusive Modular Drying function adapts drying to the load, thus shortening cycle times. A complete B cycle in just 31 minutes.



**Renewed design**  
External surfaces have flush, easy-to-clean joints that ensure hygiene. The glass touchscreen can be fully sanitised. Merging great design with practicality, the luminous panel on the front of the device clearly indicates steriliser status.



**Water management**  
An integrated demineralising filter lets you use mains water without external devices, optimising both layout and process while providing immediate savings. Sensors monitor water quality, while dedicated messages show filter status to ensure efficiency.



**Touchscreen and video tutorials.**  
The 5" capacitive display and its responsive, user-friendly controls improve day-to-day usability. Organises functions clearly and provides video tutorials to offer users a quick visual guide whenever required. A preloaded manual ensures optimal use of the device.



**Reminders**  
Proper maintenance and testing of the device maximises performance over time. Periodic Vacuum and Helix/Bowie & Dick tests, and routine maintenance, must be performed at scheduled intervals. On-screen notifications remind users to perform testing and maintenance tasks, helping them meet deadlines.



**Versatile installation**  
Customers can continue to count on a choice of 3 different volumes - 17, 22 and 28 litres - that have the same external dimensions. Optimal steriliser design and sizing allow installation on normal worktops or inside the columns designed to house these devices.

**Integrated Wi-Fi and Cloud for remote assistance and optimised control**

Connecting the autoclave to the network via the integrated Wi-Fi system or via the Ethernet links the steriliser to an integrated data management system, essential for advanced traceability. Users can also take advantage of other features

such as automatically saved cycle reports, local or remote consultation and printer management.



**SterilConnect**  
A highly innovative tool users will appreciate. Any network-connected mobile device can be used to interact with the autoclave, simplifying daily management of the sterilisation process. A clear yet complete graphic interface lets you monitor device status and manage various steriliser functions.



**Cloud Tools**  
Di.V.A. is an optional Cloud environment for sterilisation devices. Highly useful for saving cycle reports, monitoring the device or accessing video tutorials, manuals and usage statistics. EasyCheck, a Cloud-based remote support platform, ensures efficiency and reliability, shortening intervention times.



**Shared printer**  
The optional printer lets you complete the sterilisation process performed with the autoclave. To optimise management, the printer can be shared by multiple sterilisers (where enabled) and connected to the same network. One fast, reliable printing station rationalises use of space and delivers significant savings.



**QR code labels**  
Activating this function lets users produce adhesive QR code labels to apply on sterile packages at the end of every cycle. These contain unique information that identifies the steriliser, the cycle used, its outcome and the expiry date of the sterile package. It's also possible to print Barcode labels and cycle reports.



A complete array of accessories to expand the SW Plus function range

**1 EXTERNAL PRINTER**

Connected to SW Plus sterilisers, lets you print cycle-related data on thermal paper or on labels in Barcode or QR code format. To optimise management, the printer can be shared by multiple sterilisers (where enabled) and connected to the same network.

**2 FRONT FILLING KIT**

This kit allows the steriliser to be filled frontally via a quick coupling.

**3 AUTOMATIC FILLING KIT**

Consists of an external pump powered by the steriliser, allows demineralised water to be drawn from an external recipient.

**4 EV AUX KIT**

This kit allows the steriliser to be interfaced with surgery demineralising systems so the steriliser only draws water from the system as and when necessary.

**5 MODULAR TRAY HOLDER**

Modular housing system to load the steriliser. Supplied with three pairs of shelves to house trays: lets you make full use of the entire chamber diameter and insert even the bulkiest loads.

**6 BARCODE/QR CODE READER**

The reader - which can be used on most PCs - lets you complete the traceability process and pair Barcode or QR code labels with the patient.

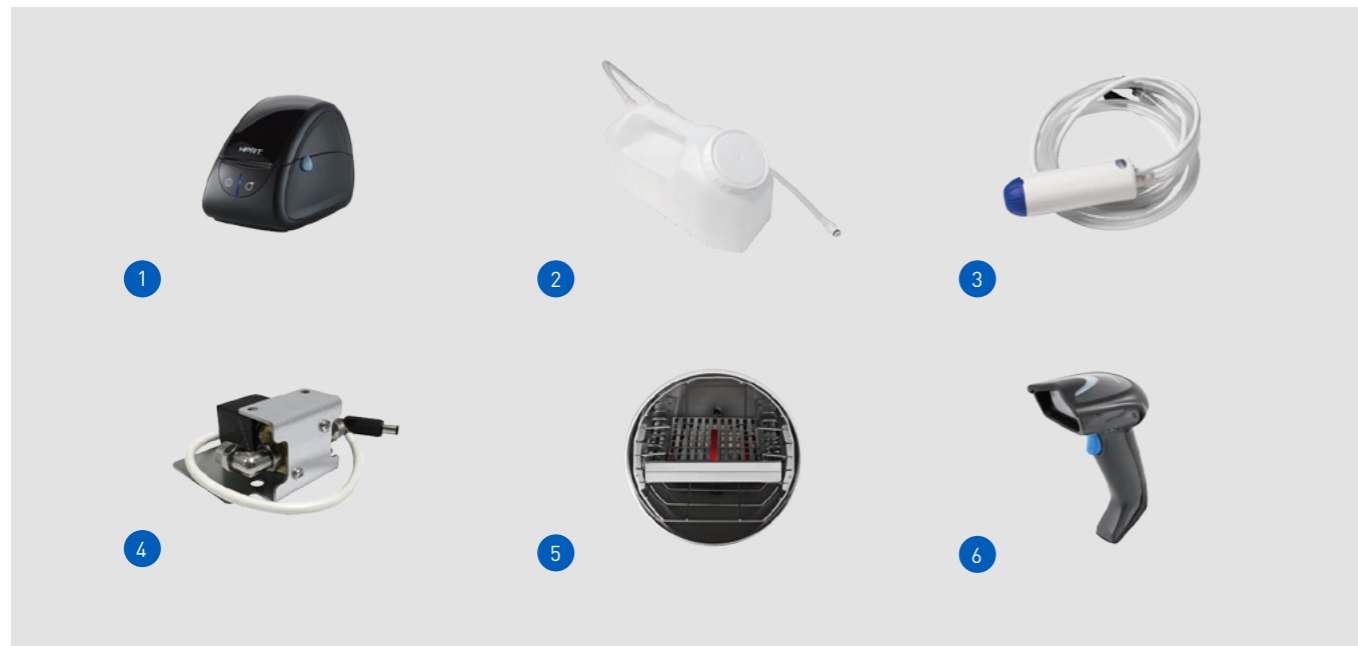

Technical data	SW 17 PLUS	SW 22 PLUS	SW 28 PLUS
Power supply	220/240 V 50Hz 220/230 V 60Hz		
Rated power	2300 W		
External dimensions (L x H x D)	500 x 490 x 600 mm		
Chamber dimensions (Diam. x Depth)	250 x 350 mm	250 x 450 mm	280 x 450 mm
Total weight	47 kg	50 kg	51 kg
Tank capacity	6l		
Autonomy (with water at maximum level)	From 7 to 11 cycles	From 6 to 10 cycles	From 5 to 9 cycles

CYCLE	Cycle type	Sterilisation time	SW 17 PLUS	SW 22 PLUS	SW 28 PLUS
		[min.]	Cycle times including sterilisation times and drying time (min.)*		
134 °C Universal	B	4	39 (31)	42 (34)	52 (44)
121 °C Universal	B	20	53 (45)	59 (51)	63 (55)
134 °C FAST	S	4	21	24	27
134 °C Packed solid instruments	S	4	32 (25)	37 (30)	41 (34)
134 °C Prion	B	18	53 (45)	57 (49)	67 (59)
Xxx °C Custom	S	Users can personalise the cycle with temperatures of 134 °C/121 °C, sterilisation times starting from 4' (134 °C) or 20' (121 °C) and drying times from 5 to 30 min.			
Vacuum Test		TEST	18	18	19
Helix/B&D Test		TEST	20	24	28
Vacuum Test + Helix/B&D Test (run in sequence)		TEST	42	46	51

\* Drying varies according to machine model and volume

Note: times in brackets show performance with modular drying activated, observing the indicated loads

Note: times do not take the pre-heat time into account

Note: the indicated times are based on an average load

Note: times may vary depending on the load and power supply



Collection



Disinfection



Washing



Rinsing



Drying



Inspection  
and maintenance



Packaging

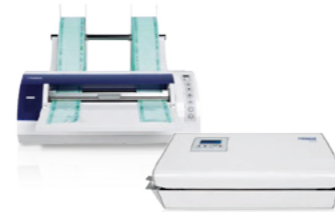

Sterilisation



Traceability



Storage



## 1 Collection

The sterilisation protocol begins with collecting instruments and materials.

## 2 Tethys H10 Plus

Designed to give you the best. The best performance in a simple and fast workflow. An innovative thermal disinfectant that replaces the numerous manual tasks typical of the stages preceding sterilisation, thus reducing workloads. Equipped with the optional HMD accessory, Tethys H10 extends the reconditioning process to rotating instruments, resulting in unparalleled performance.

## 6 Thalya - Thalya Plus

Thalya is the dentist's ally for effective maintenance of rotary instruments. Simple and user-friendly, it allows perfect lubrication and purge maintenance of turbines and handpieces. In the Thalya Plus version, the instruments also undergo a cleaning, disinfection and drying process within a single cycle.

## 7 Millseal

This thermal sealer range meets every possible need. The EVO version allows the automated creation of pouches. The Rolling version, also available with printer, combines sealing speed with flexible sizing of the packages to be sealed. The Manual version delivers user-friendliness and outstanding reliability.

## 8 Autoclaves

Stern Weber autoclaves, available in 17, 22 and 28-litre versions, simplify the operator's work by optimising time and costs. Their excellent quality and high-level functions ensure safety, reliability and ease of use.

## 9 MyTrace

MyTrace is a traceability software that allows users to associate a set of sterilised dental instruments with a patient by reading the barcode or QR code.

## 10 Storage

If carried out correctly, storage ensures long-lasting instrument sterility.

SSWPGGB1241S00

02/2025

According to the standards in force, in extra-EU areas the availability and specifications of some products and/or characteristics may vary. Please contact your local distributor for further information.



**BU Medical Equipment**  
**Sede Legale ed Amministrativa / Headquarters**  
CEFLA s.c.  
Via Selice Provinciale, 23/a  
40026 Imola (BO) - **Italy**  
**t.** +39 0542 653111  
**f.** +39 0542 653344  
sternweber.com

**Stabilimento / Plant**  
Via Bicocca, 14/C  
40026 Imola (BO) - **Italy**  
**t.** +39 0542 653441  
**f.** +39 0542 653601

